

SPIT wiring accessories

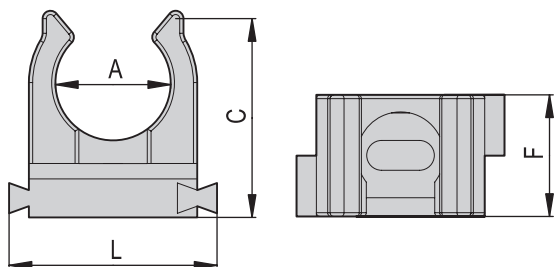

E-CLIP CONDUIT CLIP FOR CONDUIT AND PIPEWORK

- Description: Cables: Ø mini 16 – Ø maxi 50
Tubes IRL: Ø16 – Ø20 – Ø25 – Ø32 – Ø50
- Raw material: Polypropylen
- Color: Grey, RAL 7035
- Burning properties: Incandescent wire test according to CEI 695-2-1/2.: 650°C passed
- Installation temperature: T°C: -5°C / +35°C
- Working temperature: T°C: -30°C / +55°C



| SPIT E-CLIP | A | C | F | L | code |
|-------------|------|------|------|------|--------|
| D.16 | 14.7 | 26.9 | 16.1 | 27.1 | 567214 |
| D.20 | 18.6 | 29.3 | | 32.8 | 565032 |
| D.25 | 23.5 | 35.5 | | 39.1 | 565033 |
| D.32 | 30.5 | 43.5 | | 46.2 | 565034 |
| D.50 | 48.5 | 58.5 | | 64.4 | 567215 |

Pin selection guide

|  E-CLIP | C6-20 | C6-25 | C6-30 | C6-35 | HC6-15 | HC6-17 | HC6-22 | HC6-27 | HC6-32 |
|---|-------|-------|-------|-------|--------|--------|--------|--------|--------|
| Concrete C20/25 | | | ● | | | | | ● | |
| Concrete C30/37 | | ● | | | | | ● | ● | |
| Concrete C40/50 | | | | | | | ● | | |
| Prestressed / Prefabricated concrete | | | | | | | ● | | |
| Solid brick | | | ● | ● | | | | ● | ● |
| Hollow brick rendered | | | ● | ● | | | | ● | ● |
| Hollow concrete block | | | ● | ● | | | | ● | ● |
| Calcium silicate block | | | ● | ● | | | | ● | ● |
| Steel | | | | | ● | ● | | | |

Tool: P800E

SINGLE & DOUBLE CABLE BOWS: FOR LOW VOLTAGE CABLING AND TEMP LIGHTING

- Cables: 8 cables 3x1.5 (simple version)
16 cables 3x1.5 (double version)
- Raw material: Polypropylen copolymer
- Color: Grey, RAL 7035.
- Burning properties: Incandescent wire test according to CEI 695-2-1/2.: 650 °C passed
960 °C on fire version
- Installation temperature: T°C: -5 °C / +35 °C.
- Working temperature: T°C: -20 °C / +70 °C
- Fire retardant
single: 565917
double: 565918

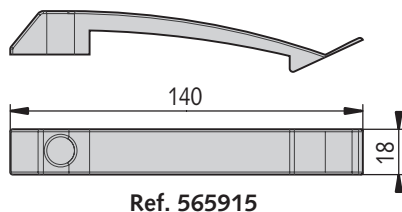

Ref. 565915

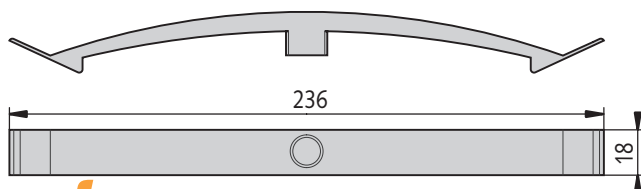

Ref. 565916

Pin selection guide

|  CABLE BOWS | C6-20 | C6-25 | C6-30 | C6-35 | HC6-15 | HC6-17 | HC6-22 | HC6-27 | HC6-32 |
|--|-------|-------|-------|-------|--------|--------|--------|--------|--------|
| Concrete C20/25 | | | ● | ● | | | | ● | ● |
| Concrete C30/37 | | | ● | | | | ● | ● | |
| Concrete C40/50 | | | | | | | ● | | |
| Prestressed / Prefabricated concrete | | | | | | | ● | | |
| Solid brick | | | ● | ● | | | | ● | ● |
| Hollow brick rendered | | | ● | ● | | | | ● | ● |
| Hollow concrete block | | | ● | ● | | | | ● | ● |
| Calcium silicate block | | | ● | ● | | | | ● | ● |
| Steel | | | | | | ● | ● | | |

Tool: P800E

SPIT wiring accessories

RECOMMENDED LOAD AND DISPLACEMENT

| Accessories | Failure load (kN) | Displacement at the failure load (mm) | Recommended load (kN) for a displacement equal to 1 mm for accessories $N_{rec} (d = 1 \text{ mm})$ |
|--------------------------------------|-------------------|---------------------------------------|--|
| Metal P-CLIP | 0.30 | 13 mm | 0.07 |
| TIE-CLIP | 0.30 | 4 mm | 0.10 |
| P-CLIP simple | 0.22 | 10 mm | 0.03 |
| P-CLIP double | 0.10 | 9 mm | 0.06 |
| CLIPLEC | 0.60 | 22 mm | 0.20 |
| E-CLIP | 0.04 | 1 mm | 0.04 |
| Single cable bows | 0.10 | 16 mm | 0.025 |
| Double cable bows | 0.16 | 16 mm | 0.04 |
| Drywall track | 1.0 | - | 0.20 |
| Wood sole plate with thickness 27 mm | 1.2 | - | 0.16 |

Check that the embedment depth is adapted to the recommended load requested for the accessories.